

INSTALLATION

Prerequisites:

concrete area:

- no holes
- no elevations
- min. 3 % slope

mats:

even temperature:
min. 5° C to max. 30° C
(store according to initial temperature)

30°C!
5°C!

! For animal well-being some litter is necessary to absorb moisture (e.g. soft milled straw or mineral material)

You will need this:

measuring:

marking:

cutting:

drilling and installing:

KRAIBURG fastening elements:

framing plugs \varnothing 10 x 100 mm with

- hexagon screw (SW 13) - A2
- washer \varnothing 30 mm - A2

(fastening elements are part of delivery)

mat width:	107 cm	112 cm	112 cm	112 cm	<p>! Do not stack the pallets! Please note: the position of the mats on the pallets is standardly NOT the right position for the installation!</p>
profile width:	+ 8 cm	+ 8 cm	+ 13 cm	+ 18 cm	
cubicle width:	115 cm	120 cm	125 cm	130 cm	

1 Lay out mat row completely and set distances by means of assembling tool

- first mark a 3 cm distance from the rear concrete edge along the whole length of the cubicle row
- start from the middle of the cubicle row and install to the right and to the left
- for the correct position of the profile under the divider (+/- 6 cm) notice that the mat width usually is at the upper tolerance level

Tip: when planning / ordering calculate with additional 4 mm per mat and e.g. lay out every 12th lying place 5 cm smaller

KRAIBURG-Logo on upper side

open cups on upper side

lay out lower mat

positioning bars

insert foam within the positioning bars

fastening points on the front edge

edges seat all around on the floor

put upper mat over it

rear concrete edge: min. 15 cm distance!

rear concrete edge: min. 3 cm distance!

Lay out more mats:

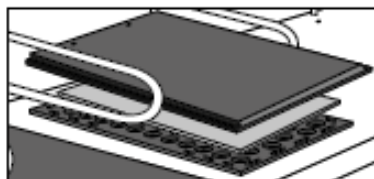

profile is more or less under the divider (maximum +/- 6 cm)

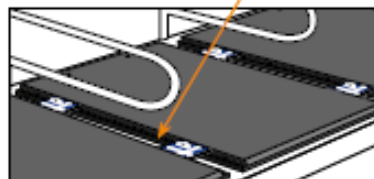

to install loosely set distance between mats by means of the assembling tool (wider than profile)

indent assembling tool about 20 cm

② Insert profiles

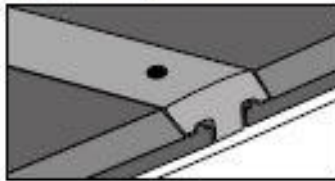

- chamfered side to rear
- flush with the rear mat edge

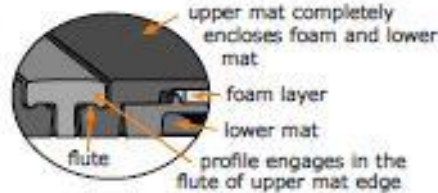

③ Fix profiles 5 x, but not yet tighten fast

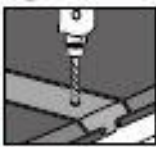

drill

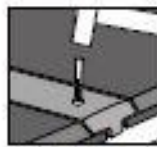

pound the plastic plugs in flush



turn in screws and washers loosely, not yet fasten tightly

profile engages in the flute of the mat edge

flute



Tip: avoid slippage:

- fix at one fastening point
- afterwards drill further holes and so on

When the whole lying mat row is already laid out and fixed loosely:

④ Fasten profiles and mats

A Fasten profiles 5 x

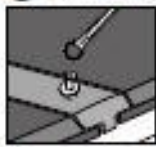

finally fasten all pre-assembled screws

B Fasten mats at front edge 2 x

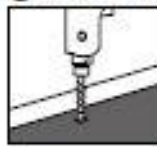

drill

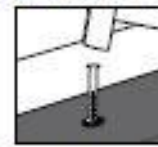

pound the plastic plugs in flush

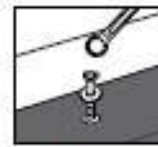

fasten screws and washers



Fasten screws until they are seated evenly fast and are slightly countersunk.
Do not over-tighten!

⑤ Fasten last side mat edge

with "end"-profile:

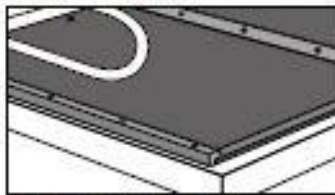

fasten with "end"-profile



or with no profile:

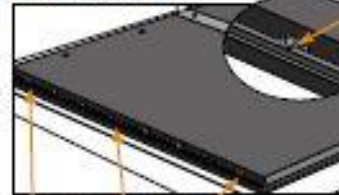

ideal position

if cut to shape:



set fastening max. 4 cm away from the upper mat edge

Mushroom dividers

upper mat:

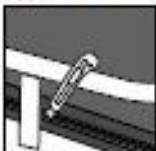

thinner side edge can be cut in up to 3 cm



profile:



if required, divide the profile, adapt it and **fasten additionally**



For adapting the profiles a handsaw or a handheld circular saw is suitable



Important: profile covers the joint over the whole mat length (also with mushroom dividers)

For more information please contact Agrizone technical service:

Phone : (450)868-2256 – E-mail : infoservice@agrizone.co - Site web: www.agrizone.ca